

EASY GUIDE TO RESET UNIFI TV APP PASSWORD

Step
1

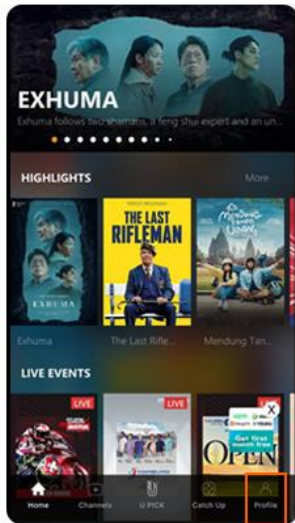

Launch Unifi TV app and select "Profile" on home page

Step
2

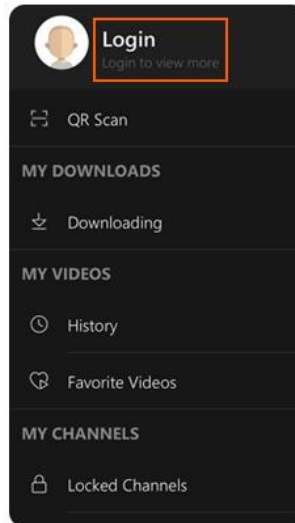

Select "Login" at the top

Step
3

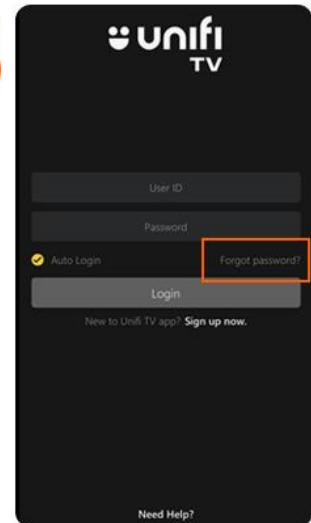

Select "Forgot password" to start reset

Step
4

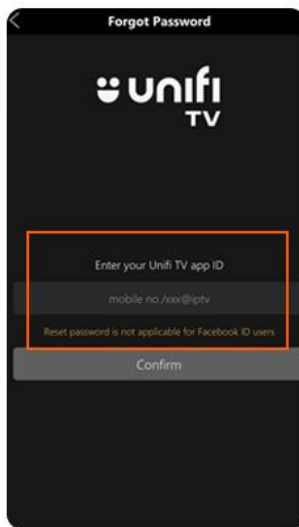

Enter your Unifi TV ID (example@iptv) or mobile number

Step
5

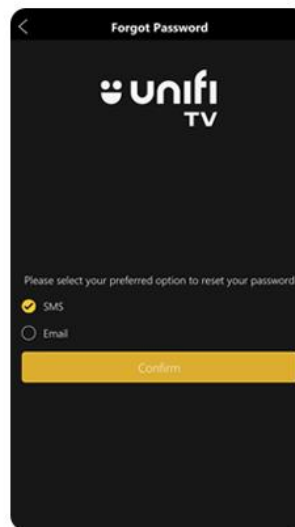

Choose your preferred method to receive the verification OTP

Step
6

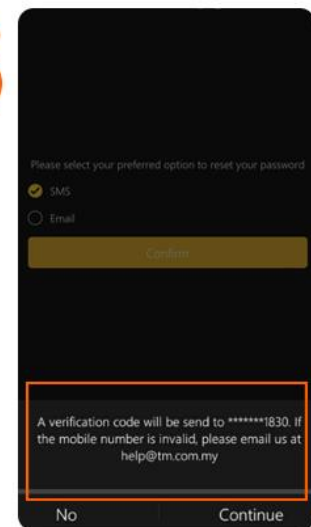

Continue with next steps to reset your new password